

# GEAR & FEED FRAME ASSEMBLY

Part No.	Description
13-B	Feed Eccentric 13 14-B-FC
14	Feed Connection <i>FITTED</i>
15	Feed Lever Only
15-FC	Feed Lever Fitted Complete
17	Feed Gear (Small)
106-B	Disc Shaft
109	Stitch Regulating Stud
110	Stitch Regulating Stud Nut
111	Stitch Regulating Block
112	Stitch Indicator
123	Feed Lever Washer
132	Feed Disc Shaft Spring
202	Set Screws
209	Feed Lever Screw
211	Feed Dog Driving Screw
228	Stitch Stud Nut
234	Feed Eccentric Pin
416	Feed Gear Only
416-FC	Right Side Feed Gear Complete
417	Feed Gear Shaft
418	Feed Gear Shaft Washer
419	Feed Gear Ring – Left and Right Side of Gear.
420	Feed Gear Cam
421	Feed Gear Roller
423	Feed Gear Roller Pin
424	Feed Gear Roller Spring
425	Feed Gear Plate
426	Feed Gear Plate Screws
427	Feed Gear Cam Set Screws
433	Feed Retaining Drum Plate Shoulder Screw
628	Feed Retaining Drum
629	Feed Retaining Drum Cam
630	Feed Retaining Drum Plate
630-FC	Left Side Feed Retaining Drum Complete

Right Side Feed Gear uses same numbers on screws,  
roller springs, pins and cams

**\*“FC” after Part Number Denotes “COMPLETE”**

**Special Gauges for Special Work are Available**

# NEEDLE BAR ASSEMBLY

Part No.	Description
7-B-51 .....	Needle Bar Yoke Eccentric
113-T .....	Needle Bar
115-T .....	Needle Bar Tension Plate
119 .....	Needle Clamp
134 .....	Needle Bar Tension Spring
202 .....	Yoke Eccentric Set Screw (2) Req'd
206 .....	Needle Bar Yoke Adjustable Bracket Screws
215 .....	Needle Bar Tension Plunger
216 .....	Needle Bar Tension Plunger Nut
217 .....	Needle Bar Tension Plate Screw
218 .....	Needle Bar Yoke Pinch screws
227 .....	Needle Clamp Screw
234 .....	Yoke Eccentric Set Pin
466-51 .....	Needle Bar Yoke (UNIT 466-51-FC)
467 .....	Needle Bar Yoke Support Shaft
468 .....	Needle Bar Yoke Support Shaft Lock Nut
469 .....	Needle Bar Yoke Adjustable Bracket
617-B .....	Needle Bar Bushing
Needle Bonis System H and F-292	

**\*\*“FC” after Part Number Denotes “COMPLETE”**

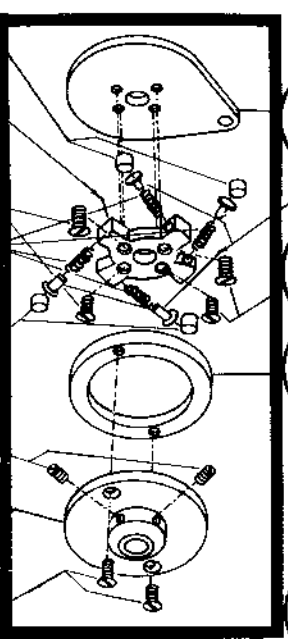
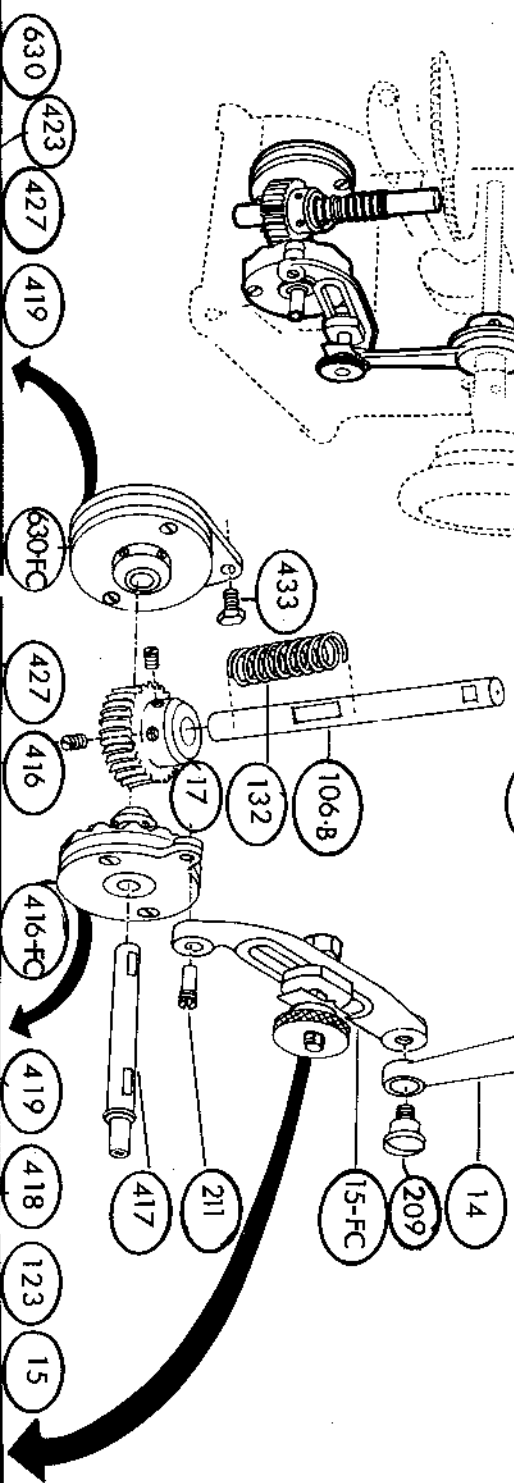
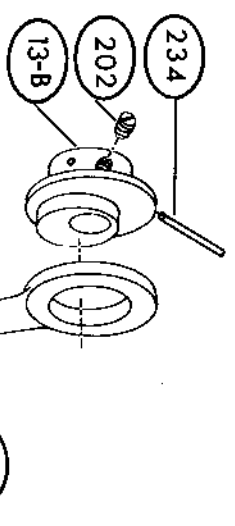
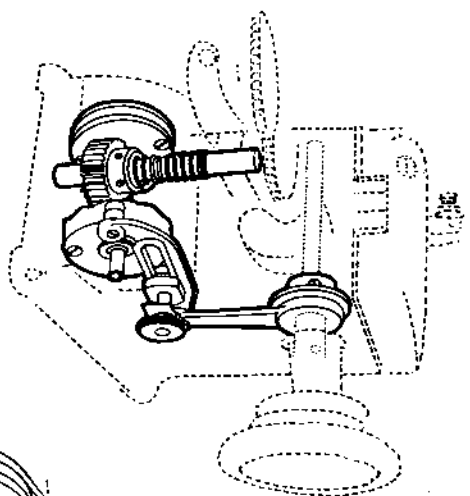

421 629 427 424 421 202 628 426  
(Left Side Feed Retaining Drum — Not Assembled)

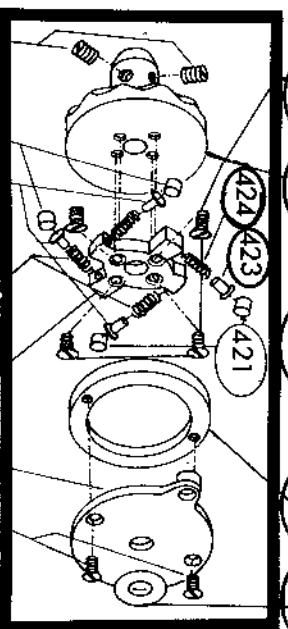

202 421 423 424 420 425 426  
(Right Side Feed Gear — Not Assembled)

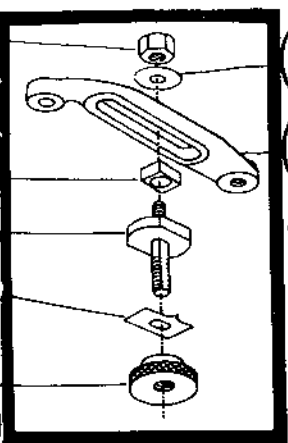

2 28 111 109 112 110  
(Feed Lever — Not Assembled)

ILLUSTRATED IN SHADOW MACHINE—GEAR AND FEED  
ASSEMBLY INSTALLED IN MAIN FRAME—COMPLETE

**CAUTION:** When ordering parts, kindly state serial number and Model of Machine. Lift top cover. . . serial number is stamped on left rear corner of main frame. Model number is stamped on metal label attached on top cover.

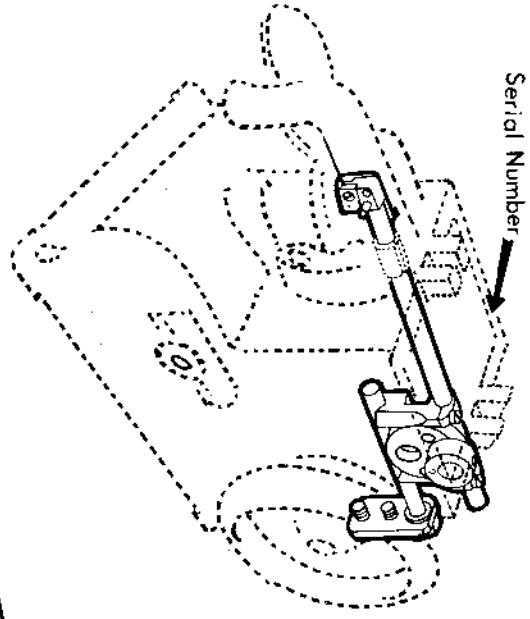

**NEEDLE BAR ASSEMBLY  
Shown INSTALLED IN MAIN FRAME**

